

**Sulzer Pumps
SALOMIX® SLR
Side Entry Agitator**



Quality and Performance

Sulzer Pumps has traditions in working for the environment and the design point of view is to save both energy and materials in agitator production. Our well equipped Mixing Research Center specializes in research of agitation technology and agitators to ensure right agitator selection procedure with low characteristic energy consumption for various needs in the pulp and paper industry.

The lifetime of our agitators is long: most of the agitators which we have supplied during the past 25 years are still on duty and when they are eventually replaced, most of the components can be recycled.

Our production processes are according to ISO 9001:2000 and ISO 14001 standards.

An agitator is always a part of a system also involving a tank. In order to achieve the correct agitation intensity in the tank, it is important that the agitator is selected to that specific application.

Agitator specialists of Sulzer Pumps always select the agitator carefully to every application, and we also give useful suggestions for the tank design so that the best performance can be achieved with minimum energy consumption.

Right agitator selection with proper tank design gives best agitation result.

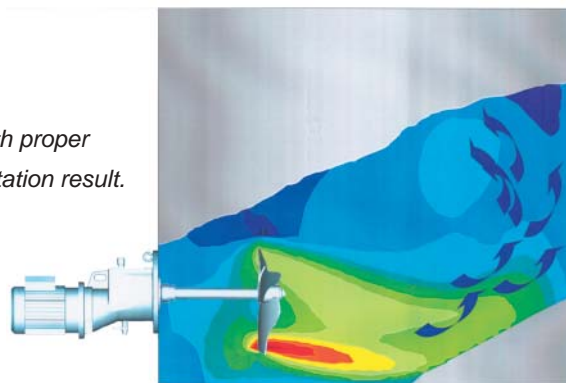

High Efficiency Chest Agitator with Proven Features for All Purposes

SALOMIX® SLR type agitator is a multi-purpose side entry agitator. It consists of high efficiency propeller, solid stainless steel shaft, reliable mechanical

seal, rugged gear reducer, elastic coupling and self aligning flange mounted motor, all in an extremely compact construction.

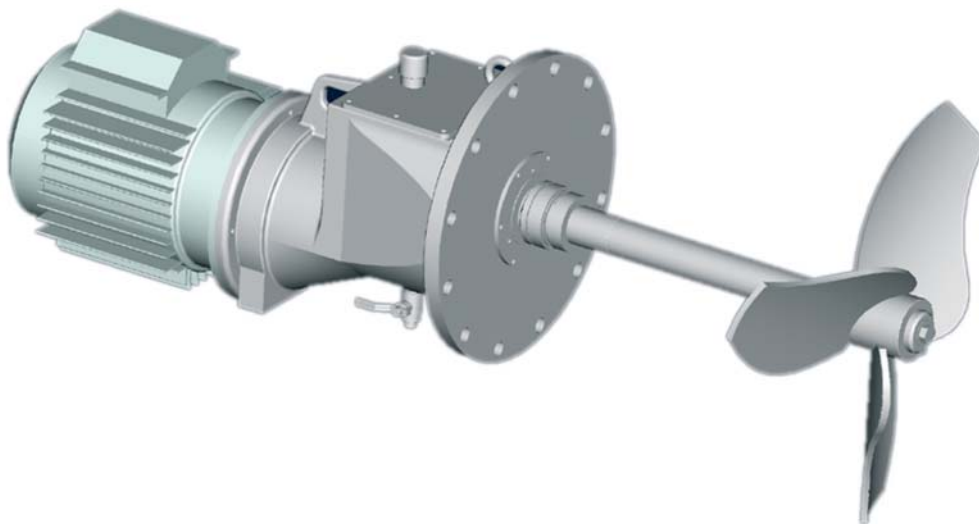

Main Dimensions

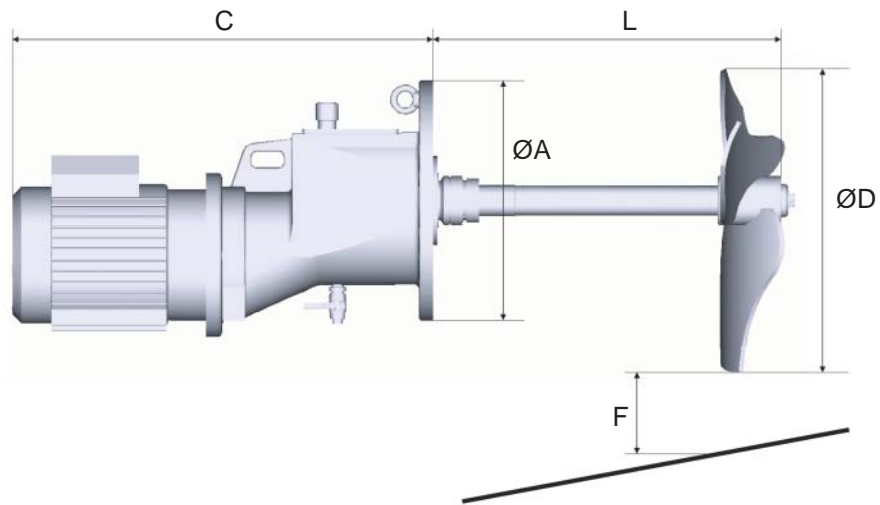

Agitator type	ØA mm	C mm	ØD mm	L mm	F mm	m* kg
SLR-30.2	440	700	315	700	150	140
SLR-40.3	440	700	400	700	200	150
SLR-40.4	440	700	400	700	200	150
SLR-50.5	440	780	500	700	200	170
SLR-63.7	440	780	630	700	200	200
SLR-63.11	440	935	630	700	200	220
SLR-80.11**	440	935	800	700	250	240

* Approximate weight includes motor weight.

** MX3 propeller.

Optional Accessories

The options are:

- support legs
- self cleaning MX2 propeller
- flushed single mechanical seal with labyrinth ring
- double mechanical seal
- seal water control unit
- tank wall ring for agitator mounting

The shape of MX2 propeller prevents possible impurities in the stock to accumulate on the propeller and is therefore used mainly in recycled fiber line tanks.

If there is a process risk to run the seal dry, flushed single mechanical seal with labyrinth or double mechanical seal is used.



Check our worldwide offices at
www.sulzerpumps.com